

Company Profile

FYOU P MEC, excellent in threading and gauging solutions, is one of the leading threading and gauging solutions supplier of API Oil Country Thread Gages, Graphite Electrodes Tread Gages, ANSI/ASME B1.20.1 /ISO 228 /BS 341/DIN 477 Thread Gages, and its measuring instruments in China. FYOU P MEC, Staying in the beautiful and industrial city, Suzhou City, China. Our products were used widely in Oil and Gas, Carbon and Metallurgical, Motor Sport, Aerospace and Defense, and Shipbuilding Industry and so on.

Since building, we do our best introducing the leading products and solutions in the world to China customers, and providing the leading products and solutions for the customers in global

At FYOU P MEC, our goal is to provide our customers with the highest quality threading and gauging solutions, service, and on time delivery available in the industry. We strive to continually upgrade our manufacturing capabilities and improve our technical abilities through continuing education of our employees and implementation of the latest technology. Our motto is FYOU, Just for you, for the customers. It is this kind of service that sets us apart from the competition

We provide the complete line of products or solutions as below:

Tube/Casing Working/Master /Taper Thread Gauge (Standard: API Spec5B:2017)

Rotary Shouldered Working/Master/Taper Gauge (Standard: API Spec7-2:2017)

SUCKER&POLISHED ROD Working / Master Gauge(Standard: API Spec11B:2017)

Graphite Electrodes Working and Master Gauges (Standard: JIS 7202: 2008)

ANSI/ASME B1.20.1 /ISO 228 /BS 341/DIN 477 Thread Ring &Plug Gauges

Thread Measuring Instrument Solutions

We are one of the whole industry chain of the threading and its gaging, inspection solutions, now, especial in Oilfield. It becomes one of the appointed suppliers for more and more large companies in Oil & Gas Industry and in Machining shop.

Contact US:

Tel: (+86) 512 68327593 Mobile(+86) 13962168423

Email: edwin@szfyou.com WhatsApp /WeChat: (+86) 13962168423

**Address: No.350 Wen Chang Road, New &Hi-tech Industrial Development Zone,
JS, China.**

Cylindrical Machined Graphite Electrodes Thread Gages

The graphite electrodes used in steel making are processed with taper internal threads at both ends. They need to be connected through the taper external threads of the graphite electrode joint of the same material. The taper threads must not only firmly connect the two electrodes, but also It must also withstand the passage of strong currents, especially high-power and ultra-high-power electric smelting, which requires higher machining accuracy for the taper threads used for graphite electrode connection.

The graphite electrode thread gauge is the instruments used for the comprehensive measuring of the graphite electrode and the taper thread on the joint. It can efficiently and accurately detect the graphite electrode thread on the spot, ensure that the contact between the electrode and the joint is kept in good condition, and greatly enhance the interchangeability of electrodes produced by different manufacturers.

1.Cylindrical Machined Graphite Electrodes Thread Form and Dimensions

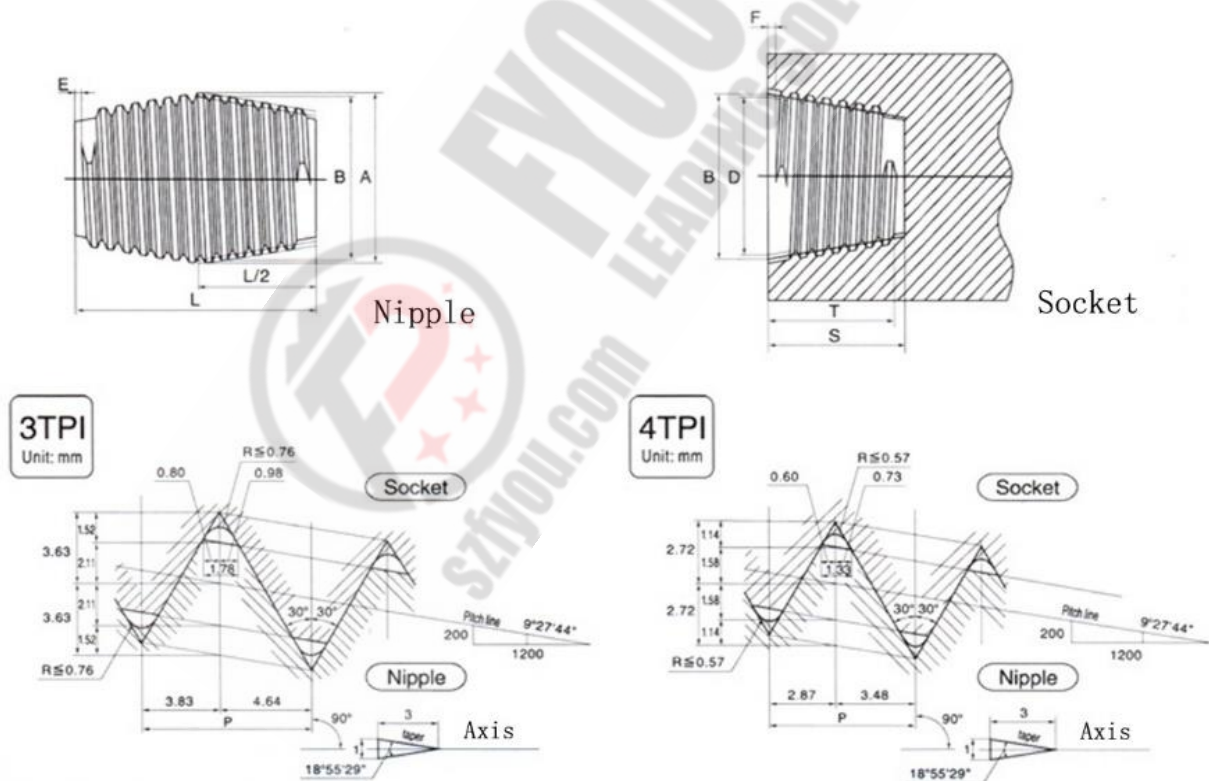

2.1 Graphite Electrodes Comparison list of Socket & Nipple With JIS&IEC&NEMA

Table 1—Comparison list of socket & nipple with JIS & IEC & NEMA (4TPI)

Units: mm

| Nominal dia. of electrode | Designation of joint | | Nipple | | | | | | Depth of Socket(l2) | | |
|---------------------------|----------------------|---------|--------------------------|--------|--------|--------------------|--------|--------|---------------------|--------|--------|
| | JIS | Old JIS | Max. diameter of pin(d1) | | | Length of pin (l1) | | | JIS | IEC | NEMA |
| | | | JIS | IEC | NEMA | JIS | IEC | NEMA | | | |
| JIS | | | | | | | | | | | |
| IEC | | | | | | | | | | | |
| NEMA | | | | | | | | | | | |
| 75 | 45T4N | 3T4 | 46.04 | 46.04 | 46.04 | 76.20 | 76.20 | 76.20 | 44.10 | 44.10 | 44.10 |
| 100 | 69T4N | 4T4 | 69.85 | 69.85 | 69.85 | 101.60 | 101.60 | 101.60 | 56.80 | 56.80 | 56.80 |
| 130 | 79T4N | 5T4 | 79.38 | 79.38 | 79.38 | 127.00 | 127.00 | 127.00 | 69.50 | 69.50 | 69.50 |
| 150 | 92T4N | 6T4 | 92.08 | 92.08 | 92.08 | 139.70 | 139.70 | 139.70 | 75.90 | 75.90 | 75.90 |
| 175 | 107T4N | 7T4 | 107.95 | 107.95 | 107.95 | 165.10 | 165.10 | 165.10 | 88.60 | 88.60 | 88.60 |
| 200 | 122T4N | 8T4 | 122.24 | 122.24 | 122.24 | 177.80 | 177.80 | 177.80 | 94.90 | 94.90 | 94.90 |
| 225 | 139T4N | 9T4 | 139.70 | 139.70 | 139.70 | 177.80 | 177.80 | 177.80 | 94.90 | 94.90 | 94.90 |
| 250 | 152T4N | 10T4 | 152.40 | 152.40 | 152.40 | 190.50 | 190.50 | 190.50 | 101.30 | 101.30 | 101.30 |
| 300 | 177T4N | 12T4 | 177.80 | 177.80 | 177.80 | 215.90 | 215.90 | 215.90 | 114.00 | 114.00 | 114.00 |
| 350 | 203T4N | 14T4 | 203.20 | 203.20 | 203.20 | 254.00 | 254.00 | 254.00 | 133.00 | 133.00 | 133.00 |
| 350 | — | — | — | 203.20 | 203.20 | — | 304.80 | 304.80 | — | 158.40 | 158.40 |
| 400 | 222T4N | 16T4 | 222.25 | 222.25 | 222.25 | 304.80 | 304.80 | 304.80 | 158.40 | 158.40 | 158.40 |
| 400 | 222T4L | 16T4L | 222.25 | 222.25 | 222.25 | 355.60 | 355.60 | 355.60 | 183.80 | 183.80 | 183.80 |
| 450 | 241T4N | 18T4 | 241.30 | 241.30 | 241.30 | 304.80 | 304.80 | 304.80 | 158.40 | 158.40 | 158.40 |
| 450 | 241T4L | 18T4L | 241.30 | 241.30 | 241.30 | 355.60 | 355.60 | 355.60 | 183.80 | 183.80 | 183.80 |
| 500 | 269T4N | 20T4 | 269.88 | 269.88 | 269.88 | 355.60 | 355.60 | 355.60 | 183.80 | 183.80 | 183.80 |
| 500 | 269T4L | 20T4L | 269.88 | 269.88 | 269.88 | 457.20 | 457.20 | 457.20 | 234.60 | 234.60 | 234.60 |
| 550 | 298T4N | 22T4 | 298.45 | 298.45 | 298.45 | 355.60 | 355.60 | 355.60 | 183.80 | 183.80 | 183.80 |
| 550 | 298T4L | 22T4L | 298.45 | 298.45 | 298.45 | 457.20 | 457.20 | 457.20 | 234.60 | 234.60 | 234.60 |
| 600 | 317T4N | 24T4 | 317.50 | 317.50 | 317.50 | 355.60 | 355.60 | 355.60 | 183.80 | 183.80 | 183.80 |
| 600 | 317T4L | 24T4L | 317.50 | 317.50 | 317.50 | 457.20 | 457.20 | 457.20 | 234.60 | 234.60 | 234.60 |
| 650 | 355T4N | 26T4 | 355.60 | 355.60 | 355.60 | 457.20 | 457.20 | 457.20 | 234.60 | 234.60 | 234.60 |
| 650 | 355T4L | 26T4L | 355.60 | 355.60 | 355.60 | 558.80 | 558.80 | 558.80 | 285.40 | 285.40 | 285.40 |
| 700 | 374T4N | 28T4 | 374.65 | 374.65 | 374.65 | 457.20 | 457.20 | 457.20 | 234.60 | 234.60 | 234.60 |
| 700 | 374T4L | 28T4L | 374.65 | 374.65 | 374.65 | 558.80 | 558.80 | 558.80 | 285.40 | 285.40 | 285.40 |
| 750 | — | 30T4 | 406.40 | — | — | 508.00 | — | — | 260.00 | — | — |
| 750 | — | — | — | 406.40 | 406.40 | — | 584.20 | 584.20 | — | 310.80 | 310.80 |
| 750 | 406T4N | 30T4L | 406.40 | 406.40 | 406.40 | 609.60 | 609.60 | 609.60 | 310.80 | 310.80 | 310.80 |

2.2 Graphite Electrodes Comparison list of Socket & Nipple With JIS&IEC&NEMA

Table 2—Comparison list of socket & nipple with JIS & IEC & NEMA (3TPI)

Units: mm

| Nominal dia. of electrode | Designation of joint | | Nipple | | | | | | Depth of Socket(l2) | | |
|---------------------------|----------------------|---------|--------------------------|--------|--------|--------------------|--------|--------|---------------------|--------|--------|
| | JIS | Old JIS | Max. diameter of pin(d1) | | | Length of pin (l1) | | | JIS | IEC | NEMA |
| | | | JIS | IEC | NEMA | JIS | IEC | NEMA | | | |
| JIS | | | | | | | | | | | |
| IEC | | | | | | | | | | | |
| NEMA | | | | | | | | | | | |
| 225 | 139T3N | 9T3 | 139.70 | 139.70 | 139.70 | 203.20 | 203.20 | 203.20 | 107.60 | 107.60 | 107.60 |
| 250 | 155T3N | 10T3 | 155.57 | 155.57 | 155.57 | 220.00 | 220.00 | 220.00 | 116.00 | 116.00 | 116.00 |
| 300 | 177T3N | 12T3 | 177.16 | 177.16 | 177.16 | 270.90 | 270.90 | 270.90 | 141.50 | 141.50 | 141.50 |
| 350 | 215T3N | 14T3 | 215.90 | 215.90 | 215.90 | 304.80 | 304.80 | 304.80 | 158.40 | 158.40 | 158.40 |
| 350 | 215T3L | 14T3L | 215.90 | 215.90 | 215.90 | 355.60 | 355.60 | 355.60 | 183.80 | 183.80 | 183.80 |
| 400 | 215T3N | 14T3 | 215.90 | 215.90 | 215.90 | 304.80 | 304.80 | 304.80 | 158.40 | 158.40 | 158.40 |
| 400 | 215T3L | 14T3L | 215.90 | 215.90 | 215.90 | 355.60 | 355.60 | 355.60 | 183.80 | 183.80 | 183.80 |
| 400 | 241T3N | 16T3 | 241.30 | 241.30 | 241.30 | 338.70 | 338.70 | 338.70 | 175.30 | 175.30 | 175.30 |
| 400 | 241T3L | 16T3L | 241.30 | 241.30 | 241.30 | 355.60 | 355.60 | 355.6 | 183.80 | 183.80 | 183.80 |
| 450 | 241T3N | 16T3 | 241.30 | 241.30 | 241.30 | 338.70 | 338.70 | 338.70 | 175.30 | 175.30 | 175.30 |
| 450 | 241T3L | 16T3L | 241.30 | 241.30 | 241.30 | 355.60 | 355.60 | 355.60 | 183.80 | 183.80 | 183.80 |
| 450 | — | 18T3 | 273.05 | — | 273.05 | 355.60 | — | 355.60 | 183.80 | — | 183.80 |
| 450 | — | 18T3L | 273.05 | — | — | 457.20 | — | — | 234.60 | — | 234.60 |
| 500 | 273T3N | 18T3 | 273.05 | 273.05 | 273.05 | 355.60 | 355.60 | 355.60 | 183.80 | 183.80 | 183.80 |
| 500 | 273T3L | 18T3L | 273.05 | 273.05 | 273.05 | 457.20 | 457.20 | 457.20 | 234.60 | 234.60 | 234.60 |
| 550 | 273T3N | 18T3 | 273.05 | — | 273.05 | 372.60 | — | 355.60 | 183.80 | — | 183.80 |
| 550 | — | 18T3L | 283.05 | — | 273.05 | 457.20 | — | 457.20 | 234.60 | — | 234.60 |
| 550 | 298T3N | 20T3 | 298.45 | — | 298.45 | 372.60 | — | 372.60 | 192.20 | — | 192.20 |
| 550 | 298T3L | 20T3L | 298.45 | 298.45 | 298.45 | 457.20 | 457.20 | 457.20 | 234.60 | 234.60 | 234.60 |

3.1 Classification of Measuring Instruments

| Measuring item | | Taper thread gauge | Instrument |
|----------------|--------------------|--------------------|---|
| Socket | Taper thread angle | Plug gauge | <ul style="list-style-type: none"> • The dial gauge specified • The hand torque wrench • Set block gauge |
| | Pitch diameter | | |
| Nipple | Taper thread angle | Ring gauge | |
| | Pitch diameter | | |

3.2 Cylindrical Machined Graphite Electrodes Thread Plug Gages

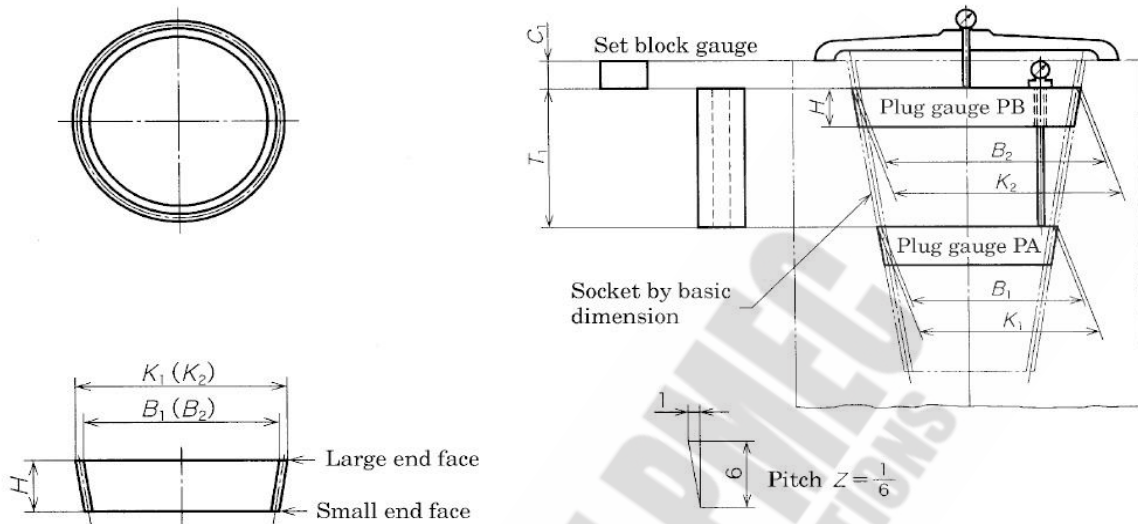

Shape of plug gauge

Combination of plug gauges

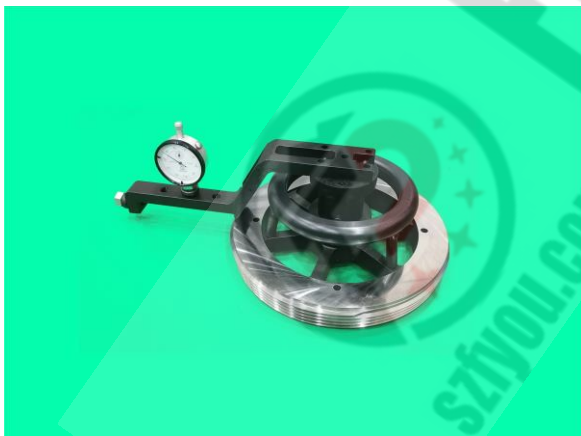

Large End Face Working Plug Gages



Small End Face Working Plug Gages

3.3 Cylindrical Machined Graphite Electrodes Thread Ring Gages

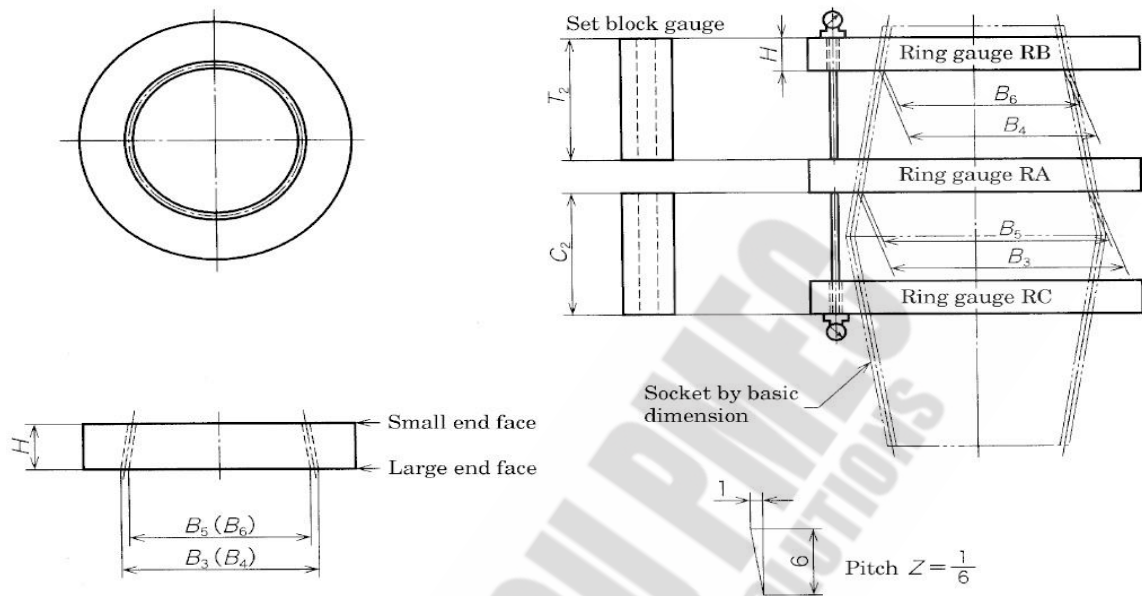

Shape of ring gauge

Combination of ring gauges



Working Ring Gages (RA、RB、RC)



Working Ring Gages and Nipple

3.4 Cylindrical Machined Graphite Electrodes Thread Master Gages

Table 5-1 Shape of taper thread master gauge, dimensions and tolerances thereon (4TPI)

Unit: mm

| Designation of thread | Major diameter at gauge diameter plane | | Pitch diameter at gauge diameter plane | | Included angle (half angle) | | Pitch of thread | | | 1/2 of taper | | Distance from gauge diameter plane to measuring reference plane |
|-----------------------|--|-----------|--|-----------|-----------------------------|-----------|-----------------|---------------------------|-------------------------------|-------------------|-------------|---|
| | Dimension | Tolerance | Dimension | Tolerance | Angle | Tolerance | Dimension | Tolerance on single pitch | Tolerance on cumulative pitch | Angle | Tolerance | |
| 8T4 | 122.238 | ±0.050 | 119.078 | ±0.020 | 30° | ±7' | 6.350 | ±0.010 | ±0.013 | 9°27'44" (1/6) | +1'20" 0 | 10 |
| 9T4 | 139.700 | | 136.540 | | | | | | | | | 86.2 ^{a)} |
| 10T4 | 152.400 | | 149.240 | | | | | | | | | 10 |
| 12T4 | 177.800 | | 174.640 | | | | | | | | | 67.15 ^{a)} |
| 14T4 | 203.200 | | 200.040 | | | | | | | | | 10 |
| 16T4 | 222.250 | 219.090 | | | | | | | | | | |
| 18T4 | 241.300 | 238.140 | | | | | | | | | | |
| 20T4 | 269.880 | 266.720 | | | | | | | | | | |
| 22T4 | 298.450 | ±0.060 | 295.290 | ±0.025 | 30° | ±8' | 6.350 | ±0.010 | ±0.020 | 9°27'44" (1/6) | +1'00" 0 | 10 |
| 24T4 | 317.500 | 314.340 | | | | | | | | | | |

Note ^{a)} They are composite taper thread master gauge of 10T and 12T, 14T and 16T respectively.

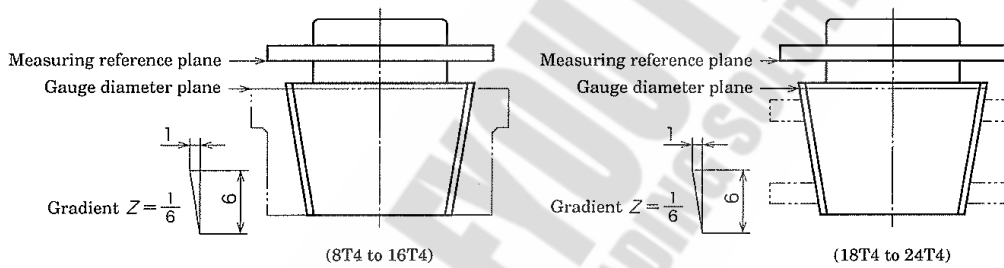

Thread Master Ring Gages



Thread Master Plug Gauge

Table 5-2 Shapes of taper thread master gauge (divided type), dimensions and tolerances thereon (4TPI)

Unit: mm

| Designation of thread | Type of gauge | Major diameter at gauge diameter plane | | Pitch diameter at gauge diameter plane | | Included angle (half angle) | | Pitch of thread | | | 1/2 of taper | | Distance from gauge diameter plane to large end face | |
|-----------------------|---------------|--|-----------|--|-----------|-----------------------------|-----------|-----------------|---------------------------|-------------------------------|-------------------|-------------|--|---------|
| | | Dimension | Tolerance | Dimension | Tolerance | Angle | Tolerance | Dimension | Tolerance on single pitch | Tolerance on cumulative pitch | Angle | Tolerance | | |
| 26T4 | MPA | 309.667 | ±0.060 | 306.507 | ±0.025 | 30° | ±8' | 6.350 | ±0.010 | ±0.018 | 9°27'44" (1/6) | +1'00" 0 | 137.800 | |
| | MPB | 352.267 | | 349.107 | | | | | | | | | 10 | |
| 28T4 | MPA | 328.717 | | 325.557 | | | | | | | | | 137.800 | |
| | MPB | 371.317 | | 368.157 | | | | | | | | | 10 | |
| 30T4 | MPA | 360.467 | | 357.307 | ±0.030 | | | | | | | | ±10' | 137.800 |
| | MPB | 403.067 | | 399.907 | 10 | | | | | | | | | |

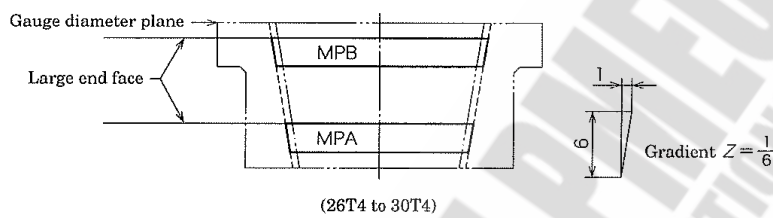

Working Plug Gauge VS Master Ring Gauge



Working Ring Gauge VS Master Plug Gauge

Table 5-3 Shapes of taper thread master gauge, dimensions and tolerances thereon (3TPI)

Unit: mm

| Designation of thread | Major diameter at gauge diameter plane | | Pitch diameter at gauge diameter plane | | Included angle (half angle) | | Pitch of thread | | | 1/2 of taper | | Distance from gauge diameter plane to measuring reference plane | | | | | | | |
|-----------------------|--|-----------|--|-----------|-----------------------------|-----------|-----------------|---------------------------|-------------------------------|-------------------|-------------|---|-----|--------|--------|--------|--------|--------|--------|
| | Dimension | Tolerance | Dimension | Tolerance | Angle | Tolerance | Dimension | Tolerance on single pitch | Tolerance on cumulative pitch | Angle | Tolerance | | | | | | | | |
| 9T3 | 139.700 | ±0.050 | 135.488 | ±0.020 | 30° | ±7' | 8.467 | ±0.010 | ±0.013 | 9°27'44" (1/6) | +1'20" 0 | 10 | | | | | | | |
| 10T3 | 155.575 | | 151.363 | | | | | | | | | | | | | | | | |
| 12T3 | 177.165 | | 172.953 | | | | | | | | | | | | | | | | |
| 14T3 | 215.900 | ±0.060 | 211.688 | ±0.025 | | | | | | | | | ±8' | ±0.018 | ±0.018 | ±0.018 | ±0.018 | ±0.018 | ±0.018 |
| 16T3 | 241.300 | | 237.088 | | | | | | | | | | | | | | | | |
| 18T3 | 273.050 | | 268.838 | | | | | | | | | | | | | | | | |
| 20T3 | 298.450 | | 294.238 | | | | | | | | | | | | | | | | |

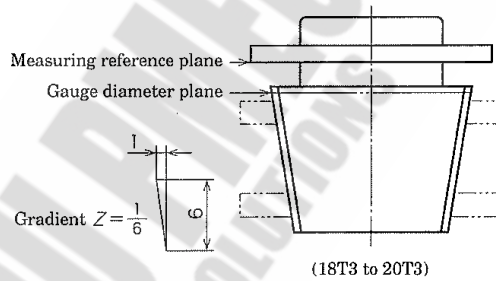
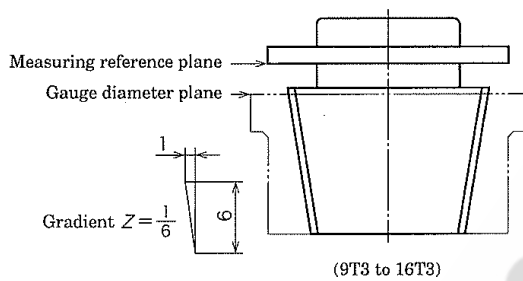

Thread Master Ring Gages



Thread Master Plug Gauge

4. Calibration Certificates

4.1 All the Working and Master Gages will come with calibration certificates issued by our manufacturers. The following item shall be included in the report if necessary.

- Number of the Standard and Name;
- Measurement day and Measurement environment;
- Product number of socket
- Angle of taper thread of socket
- Pitch diameter of taper thread of socket
- Product name of Nipple
- Angle taper thread of nipple
- Pitch diameter of taper thread of nipple
- Other special instruction as your request.

4.2. Also, if requested, we would like to support you to do the calibration by the NIM (Beijing, National Institute of Metrology, China), Please refer as below sample :

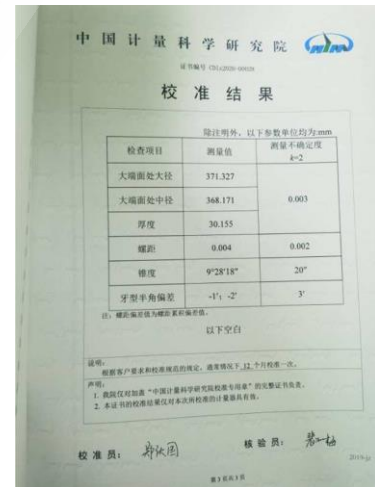
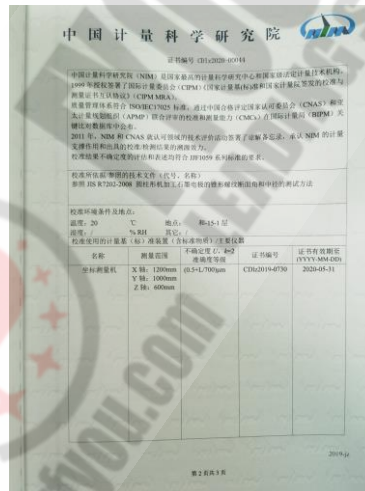
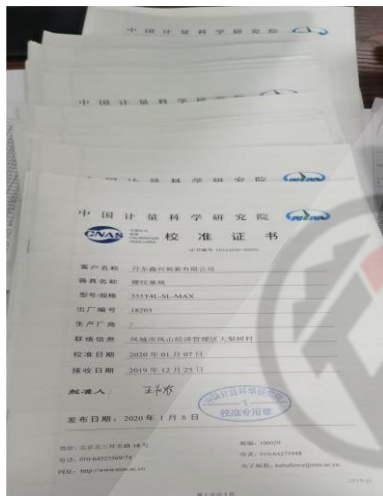

Request of the Quotation

If you have any request or questions please contact us freely as below:

E-mail: edwin@szfyou.com Mobile: + 86 139 6216 8423

WhatsApp / We Chat: + 86 139 6216 8423